

WELCOME TO PHILLIPSBURG!

Phillipsburg City Wide Garage Sales

Saturday, April 25, 2009

Starting at 8:00am---????

(Notice-Some sales will start on Friday evening. See below!)

Sponsored by the Phillipsburg Area Chamber of Commerce

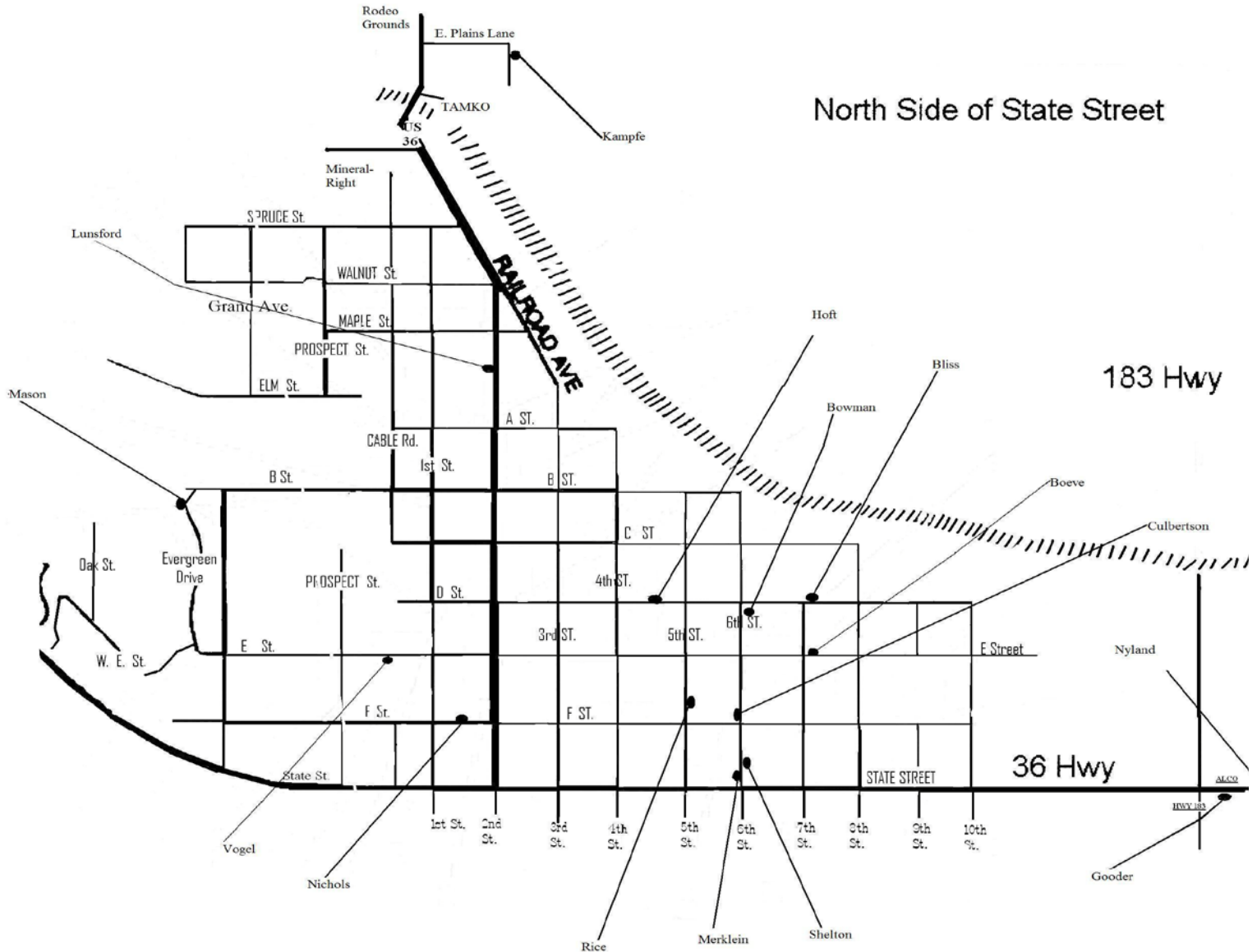

NO.	NAME	ADDRESS	NO. of FAMILIES	KEY ITEMS
1.	Kampfe	1580 E. Plains Lane	2	Computer desk, Furniture, Knick Knacks
2.	Hoft/James/Lenker	467 D Street	3	TV, Bunch of Misc.
3.	Bowman	992 6 th St.	1	Exercise Equip, Electronics, arcade Bball games
4.	Bliss	1084 7 th St.	4	
5.	Boeve	731 E St.	2	Toddler Clothes (boys & girls), baby items
6.	Culbertson	887 6 th St.	1	Furniture, Angel Col., Santa Col., Glassware
7.	Nyland	123 E. Hwy 36	2	Kids Clothes, Ice Chest, Knick-Knacks, Misc.
8.	Gooder (Friday 5pm -??)	134 E. Hwy 36	3	Sofa's, Tables, Swivel Rocker
9.	Shelton	Phillips Co. Health Dept.-784 6 th St.	2	Infant boys and girls clothes, Misc. Household
10.	Merklein (Friday 5pm-8pm)	735 6 th St.	2	Glider Chair, Dorm Refrigerator, Chest of Drawers
11.	Rice	892 5 th St.	2	Sporting Goods, Beds, lawn mower
12.	Nichols	291 F St.	2	
13.	Vogel (Friday 9am-6pm)	244 West E. St.	3	Matching Couch & Love Seat, Wingback Chair
14.	Mason	1121 Evergreen Drive.	1	Dresser & Hutch mirror, Bicycles, Elec. Grinder,, Misc.
15.	Lunsford	1493 2 nd St.	2	DVD's & misc.